

Before installing this product, check the contents of the kit. If anything is missing, please contact your Öhlins dealer.

Kit Contents	Part No	Pcs
Front Fork kit	FGMA 995	1
O-ring	00338-10	2
O-ring	00338-35	2
O-ring	00438-86	2
O-ring	00438-98	2
Base plug	15430-05	2
Circlip	15440-01	2
Spacer 2 mm	15443-02	10
Spacer 3 mm	15443-03	2
Hydraulic stop cup	15456-04	2
Öhlins Sticker	00197-01	2
TTX Cartridge Sticker	00191-29	2
Owner's Manual/ Mount Instr FGMA995	07296-80	1

**👁 Note!**

Order Oil and Spring Kit separately. For correct spring rate see Spring Guide in this manual. Use Öhlins Front Fork fluid 01312-xx only.

Please note that during storage and transportation, especially at high ambient temperature, some of the oil and grease used for assembling may leak and stain the packaging. This is in no way detrimental to the product, wipe off the excessive oil/grease with a cloth.

**⚠ Warning!**

Before installing this product, read this manual carefully. The front fork is an important part of your vehicle and may affect the stability. The installation procedure requires certain tools.

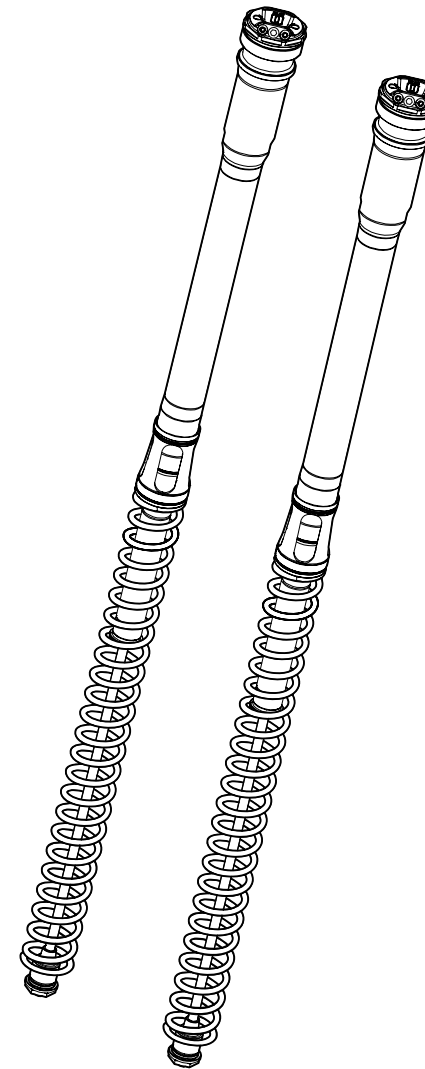

👁 Öhlins products are subject to continuous improvement and development, therefore, although these instructions include the most up-to-date information available at the time of printing, minor updates may occur.

To find the latest information contact your Öhlins distributor. Please consult your Öhlins dealer if you have any questions regarding the contents in this document.

Part no. 07296-80\_0  
Issued 2009-04-22



© Öhlins Racing AB. All rights reserved. Any reprinting or unauthorized use without the written permission of Öhlins Racing AB is prohibited.

Öhlins Racing AB  
Box 722  
S-194 27 Upplands Väsby, Sweden  
Phone +46 8 590 025 00  
fax +46 8 590 025 80



[www.ohlins.com](http://www.ohlins.com)

## Öhlins Front Fork Kit for Marzocchi 50 **FGMA 995**

### Owner's Manual - Mounting Instructions



## 👁️ Note!

The front fork is a very important part of the vehicle and will therefore affect the stability.

👁️ Read and make sure that you understand the information in this manual and the mounting instructions before you use this product. If you have any questions regarding installation or maintenance please contact your Öhlins dealer.

👁️ Öhlins Racing AB can not be held responsible for any damage to the front fork, vehicle, other property or injury to persons, if the instructions for installing and maintenance are not followed exactly.

## ⚠️ Warning!

This product was developed and designed exclusively for a specific vehicle model and should only be installed on the intended vehicle model in its original condition as delivered from the vehicle manufacturer.

⚠️ This product contains pressurized nitrogen gas (N<sub>2</sub>). Do not open, service or modify this product without proper education (authorized Öhlins dealer/distributor) and proper tools.

⚠️ After installing this product, take a test ride at low speed to make sure that your vehicle has maintained its stability.

⚠️ If the suspension makes an abnormal noise, or the function is irregular, or if you notice any leakage from the product, please stop the vehicle immediately and return the product to an Öhlins Service Centre.

## 👁️ Note!

When working on this product, always consult your Vehicle Service Manual.

👁️ This Manual should be considered as a part of the product and should therefore accompany the product throughout its life cycle.

## Safety Symbols

In this manual, mounting instructions and other technical documents, important information concerning safety is distinguished by the following symbols:



The Safety Alert Symbol means: Warning! Your safety is involved.

## ⚠️ Warning!

The Warning Symbol means: Failure to follow warning instructions can result in severe or fatal injury to anyone working with, inspecting or using the front fork, or to bystanders.

## 👁️ Caution!

The Caution Symbol means: Special precautions must be taken to avoid damage to the front fork.

## 👁️ Note!

The Note Symbol indicates information that is important regarding procedures.

© Öhlins Racing AB. All rights reserved. Any reprinting or unauthorized use without the written permission of Öhlins Racing AB is prohibited.  
Printed in Sweden.

## Spring Guide

Brand	Rider's weight*	Spring	Spring rate
	kg/pounds		N/mm
<b>Motocross/Enduro</b>	70/154	08784-41	4,1
	75/165	08784-43	4,3
	80/176	08784-45	4,5
	85/187	08784-45	4,5
	90/198	08784-47	4,7
	95/209	08784-47	4,7

\* Rider's weight: Rider wearing all riding equipment

## Inspection and Maintenance

Preventive maintenance and regular inspection reduces the risk of functional disturbance.

### Breather plug

Make sure to aerate the front fork at regular intervals:

1. Put the motorcycle on a workstand so that the front wheel barely touches the ground.
2. Loosen the breather plug to release excessive pressure in the front fork.

### Recommended Service Intervals

Every 25 hours. Make your service and maintenance according to Öhlins Workshop manual.

### Disposal

Discarded Öhlins products should be handed over to an authorized Öhlins workshop or distributor for proper disposal.

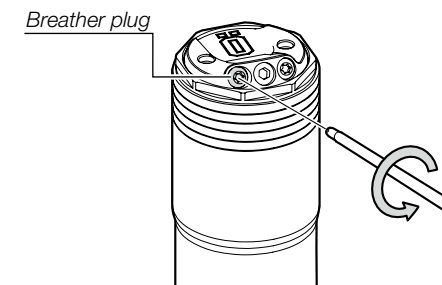

## Compression damping adjuster

The compression adjuster is located at the top of the fork leg. Adjust by turning the screw with a 3 mm allen key.

Compression damping adjuster

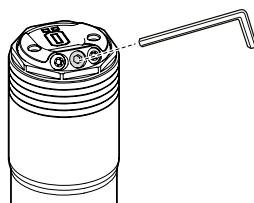

## Rebound damping adjuster

The rebound adjuster is located at the bottom of the fork leg. Adjust by turning the screw with a 3 mm allen key.

Rebound damping adjuster

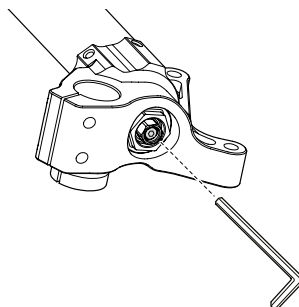

## To Reset

The adjusters have a normal right hand thread. Turn the damping adjusters gently clockwise to fully closed (pos. zero [0]). To open, turn counter clockwise, and count the clicks until you reach the recommended number. For recommended clicks see Set-up data. Static sag can only be changed with softer or harder spring rate.

## Caution!

*Do not use too much force, delicate sealing surfaces can be damaged.*

## Note!

*The total stroke of the front fork may differ from the original stroke, so that more or less of the steel tube will be visible when the fork is fully compressed.*

## Diagram: Oil Volume - Force



## In This Manual

Recommended Tools	2
How to Install	3
Replace Spring	6
Set-up	7
Set-up Data	8
Spring Preload	8
Adjustments	9
Oil Volume - Force Diagram	9
Spring Guide	10
Inspection and Maintenance	10

## Recommended Tools

- OEM Fork Cap Tool
- Socket 22 mm (Bottom Plug)
- Socket 12 mm (Shaft end Adjuster Housing)
- Pliers (for the security snapping)
- Tool 01890-01 Plug
- Fork Cap Tool octagon 50 mm
- Inner tube Clamp Tool 50 mm

## Remove the fork legs from the vehicle

### ⚠ Warning!

It is advisable to have an Öhlins dealer install the front fork kit.

When installing, consult your Vehicle Service Manual.

- Put the motorcycle on a workstand so that the front wheel barely touches the ground.

### ⚠ Warning!

Make sure the vehicle is securely supported so that it will not tip.

- Remove the front wheel and the brake caliper.
- Measure the distance from the top of the fork leg to the top of the upper triple clamp according to figure.

### 👁 Note!

Note this dimension as fork height position.

- Loosen the upper triple clamp by loosening the screws.
- Loosen (but not remove) the top cap 1/2 turn. Use the OEM Fork Cap tool from the motorcycle manufacturer.
- Loosen the lower triple clamp by loosening the screws.
- Remove the front fork legs from the motorcycle.

- Clean the fork legs thoroughly. Make sure to clean underneath the fork bottoms.

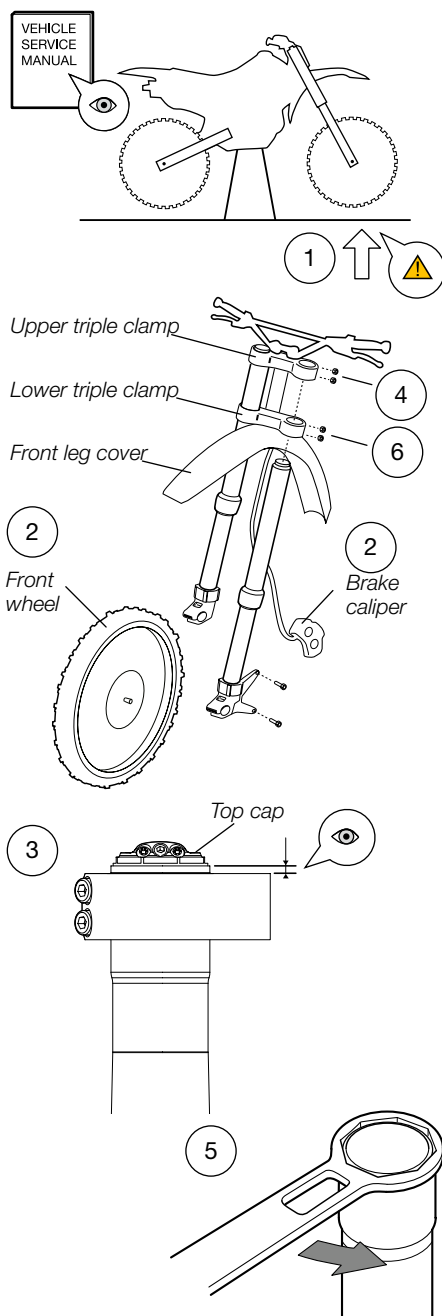

## Set-up Data

Rebound damping 15 click  
 Compression damping 15 click  
 Spring preload 1 mm  
 Oil volume 0,420 litre

Spring preload range -2 to 8 mm  
 (can be adjusted by adding/removing washers 15443-xx)

Oil volume range 0,300-0,450 litre  
 Öhlins Front Fork fluid 01312-xx

Fork springs may differ in length. Therefore we recommend you to check the preload on each fork leg and, if necessary, install preload washers to get the correct value. A negative preload of up to minus 2 mm is possible, since the top-out spring still gives a small compression on the main spring.

Preload less than -2 mm will make the fork spring loose when the front wheel is off the ground, which increases wear inside the fork.

### 👁 Caution!

Preload washers must be placed below the spring, otherwise they will restrict oil flow and the fork may break.

## Measure Spring Preload

Measure the spring preload according to the following steps;

- Measure A. Fork outer tube should be slid down to stop and cartridge pulled out to distinct stop (requires a force of about 30 kg).
- Measure B.
- Measure C.
- Calculate preload:  $\text{Preload} = B - A - C$
- Adjust preload according to the desired value according to set-up data, by adding/removing preload washers below the spring.

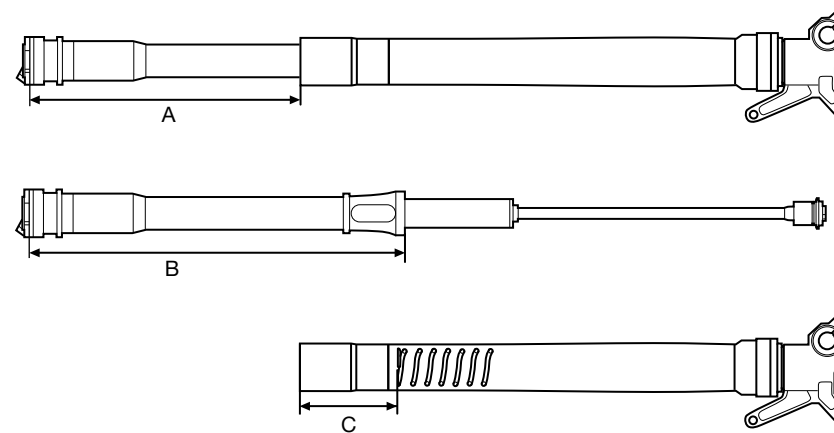

### ⚠ Warning!

Before riding, always ensure that the basic settings made by Öhlins are intact. Take notes, adjust in small steps and make only one adjustment at a time.

## Step 1

### Check Sag and Ride Height

#### 👁 Note!

The following procedure should be performed on a flat surface.

1. Put the motorcycle on a workstand so that both wheels are off the ground and the suspension is unloaded.
2. Mark, for example with a piece of tape, a point immediately above the rear wheel axle.
3. Measure the distance from the marked point to a fixed point, for example the wheel axle. (See figure below: R1)
4. Measure the distance from the bottom of the upper triple clamp to a fixed point, for example the front wheel axle. (F1)
5. Put the motorcycle on the ground so that the front and the rear suspensions are slightly compressed. Repeat the measuring procedures. (R2 and F2)
6. Sit on the motorcycle in normal riding position, properly outfitted in your riding gear. Repeat the measuring procedures. (R3 and F3)

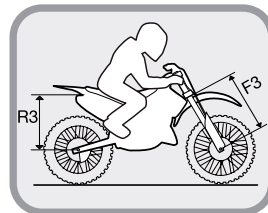
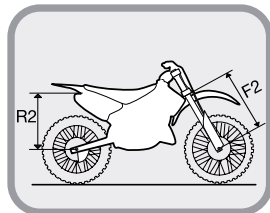
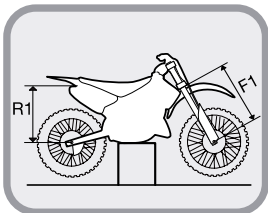

### Recommended Measures

If no other recommendations are given in the Vehicle Manual follow the measures below:

#### Free sag (R1-R2)

Rear 30±10 mm

#### Ride height (R1-R3), (F1-F3)

Rear 100±10 mm

Front 45±10 mm

## Step 2

### Adjust spring preload

1. If your measurements differ significantly from the recommendations from the table above, adjust the spring preload. (See section Spring Preload in this manual).
2. If the ride height still differs from the recommendations, you may need to change spring. Contact your Öhlins dealer for advise.

### ⚠ Warning!

Incorrect spring rate may produce a fork angle that is too steep or too flat. This in turn will give a tendency for over- or understeering, which could seriously affect the handling characteristics of the motorcycle.

### Disassemble the original front fork

#### 9

Follow your vehicle service manual to remove the original front fork kit and spring from the fork leg. Turn the fork leg upside down to pour out the oil.

#### Remove OEM Hydraulic Stop Tube

👁 Not necessary on all models.

1. Remove the lock screw. If the lock screw has damaged inner tube threads, clean them by grinding or milling. Do not go deeper than thread bottom diameter.
2. Use a heating gun to release thread locking agent.
3. Unthread inner tube from the fork bottom.
4. Remove the OEM Hydraulic stop tube.
5. Install the Öhlins seal platform and two o-rings.
6. Reinstall the inner tube into fork bottom. Thread lock: Loctite 649. Tightening torque: 210 Nm.
7. Install lock screw.

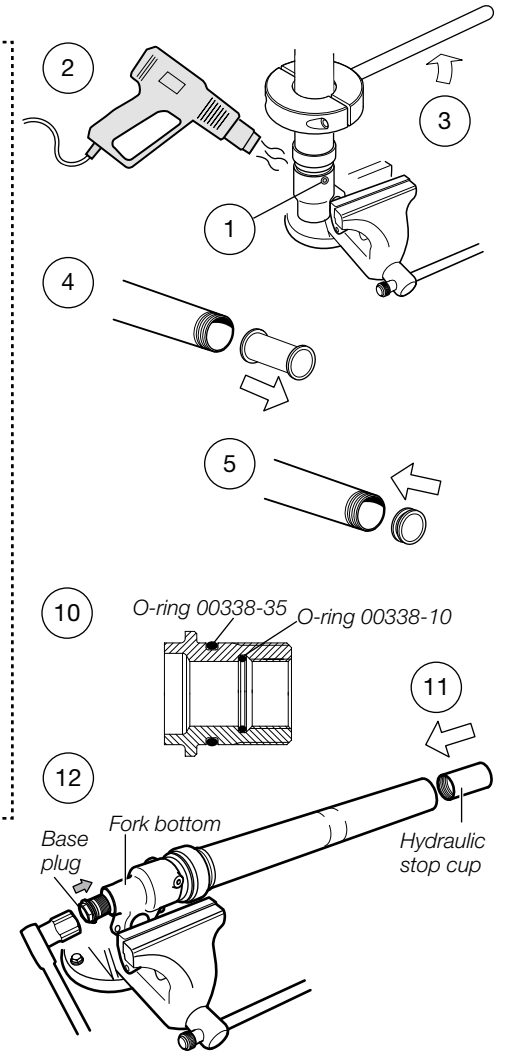

### Install the Öhlins front fork kit

10. Smear some red grease or similar on the o-rings and install them onto the base plug according to figure.
11. Install the hydraulic stop cup from the upper end of the fork tube. Clean contact surfaces between the hydraulic stop cup and fork bottom with contact cleaner.

### 👁 Caution!

Make sure that the hydraulic stop cup is well seated before tightening.

# How to Install

## 12

Install and tighten the base plug into the fork bottom, use a 22 mm socket (tightening torque 45 Nm).

### ⚠ Caution!

If the hydraulic stop cup is turning, carefully use an impact machine.

## 13

Install optional preload washer(s) 15443-xx (optional - see **Set-up data**, **Spring preload**), the recommended Öhlins spring (see **Spring guide**) and the cartridge kit into the standard fork leg.

### 👁 Note!

The preload washers must be below the spring, at the bottom end of the fork leg.

## 14

Tighten the cartridge shaft end into the base plug by turning counter clockwise. Use a 12 mm socket (tightening torque 18 Nm).

## 15

Install the security snap-ring at the shaft end groove according to figure.

## 16

Pour Öhlins Front Fork Fluid in the fork leg according to the recommended settings.

## 17

Tighten the Öhlins fork top cap gently. Use the 50 mm octagon Fork Cap Tool. Tightening torque maximum 10 Nm.

## 18

Check and set the rebound and compression valves click positions according to the recommended settings in **Set-up data**.

## 19

Install the front fork legs into the triple clamps. Use, to begin with, the same height position as before. Tightening torque - see your Vehicle Service Manual. Reinstall the brake caliper and front wheel.

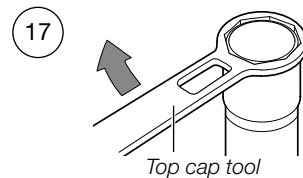
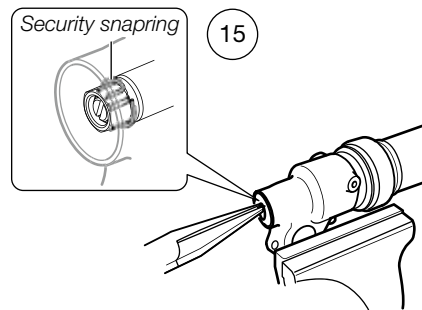
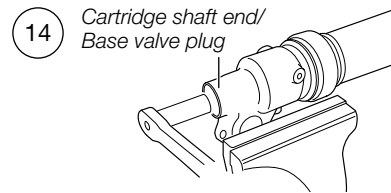
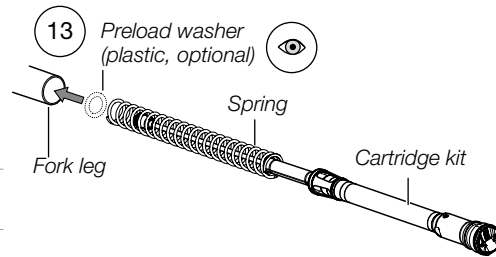

Make sure that all removed parts are reinstalled as they were before the installation of the Öhlins Front Fork Kit.

### 👁 Note!

It is very important that the triple clamps are tightened to the correct torque. See your Vehicle Service Manual.

# How to Install

## Replace Spring (only)

### 1

Follow steps 1-8 in chapter *Remove the fork legs from the vehicle*.

### 2

Remove the security snapping in the bottom of the fork with a pair of pliers.

### 3

Loosen the bottom end of the cartridge kit by turning clockwise.

### 4

Install the tool 01890-01 (oil plug) by pushing it into the fork bottom. The plug will keep the oil in the fork while changing the spring.

### 5

Remove the cartridge kit from the fork leg and change the spring. Note the plastic preload washer(s) (if any).

### 👁 Note!

The preload washers must be below the spring, at the bottom end of the fork leg.

### 6

Install the cartridge kit into the fork leg and push out the oil plug tool 01890-01.

### 7

Tighten the shaft end (counter clockwise) into the fork bottom with tightening torque 18 Nm.

### 8

Install the security snapping.

### 9

Tighten the Öhlins fork top cap gently. Use the 50 mm octagon Fork Cap Tool. Tightening torque maximum 10 Nm.

### 10

Install the front fork legs into the triple clamps. Use, to begin with, the same height position as before. Tightening torque - see your Vehicle Service Manual. Reinstall the brake caliper and front wheel - make sure that all removed parts are reinstalled as they were before the installation of the Öhlins Kit.

